



# 1 1/4" BORE CORROSION RESISTANT CYLINDER

## CR-SDD-20-□-□

Mount: Stud  
Type: Double Rod

Standard Stroke Lengths: 1", 2", 3", 4", 5", 6"  
Options: M, V, N, P6, P7, P8

For magnetic option add .312

Double Acting

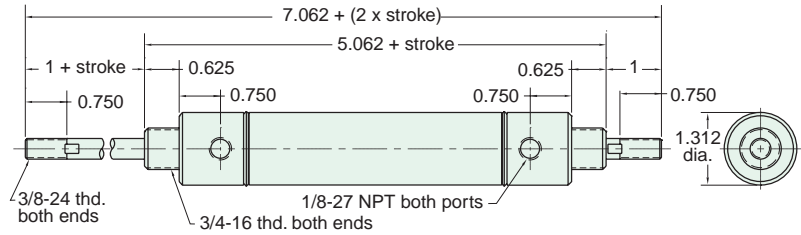

Furnished without nut(s). Order Part No. N12-16-SS.

## CR-SDR-20-□-□

Mount: Stud  
Type: Rotating Rod

Standard Stroke Lengths: 1/2", 1", 1-1/2", 2", 3", 4", 5", 6"  
Options: M, V, N

For magnetic option add .312

Double Acting

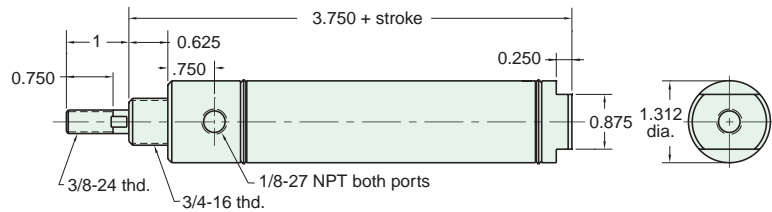

Furnished without nut(s). Order Part No. N12-16-SS.

## CR-UDR-20-□-□

Mount: Universal  
Type: Rotating Rod

Standard Stroke Lengths: 1/2", 1", 1-1/2", 2", 3", 4", 5", 6", 8", 10", 12"  
Options: M, V, N, P2, P3, P4, P5, P6, P7, P8

For magnetic option add .312

Double Acting

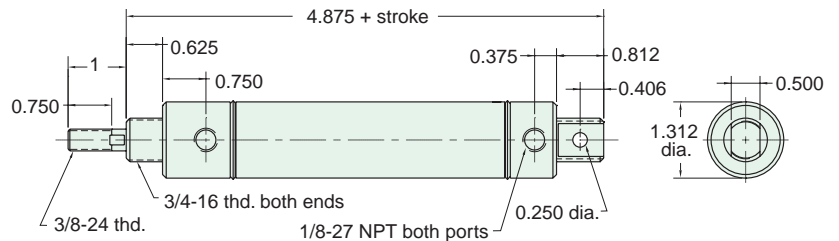

Furnished without nut(s). Order Part No. N12-16-SS.

## Stainless Steel Mounting

Foot Bracket  
Model Number: FB-2491-SS

Nut  
Model Number: N12-16-SS  
Max. Torque in lbs.: 20

